

Arrangements for weddings and funerals will be made on an individual basis. Knowing that, I have been in conversation with other parishes to accommodate these needs and I hope to provide more information in the coming weeks.

I will work with Revera to see if we can find a way of transporting residents from Windermere on the Mount to King's, so that we continue to share fellowship with seniors in our community.

Will we miss the space? Will we miss the windows and the marble and the art? Of course we will.

More importantly, I am aware that we are a strong community that will be able to celebrate our identity as disciples of the Risen Christ in whatever location we find ourselves. Our vision extends far beyond "The Chapel" and as a community, our reach has extended to the Canadian North, the core of the City of London and to Rwanda, Iraq and Syria.

Finally, I believe that as a university community, we need to be on the campus if we are going to have a credible voice in shaping a Catholic vision for post-secondary education in the city and within the Diocese of London.

It will take a few weeks to sort out some of these details. I invite you to join me and the rest of the pastoral team following our Eucharist honouring Christ the King on Sunday, November 20, 2016. We will have coffee, pastries and hopefully a bit more information.

This move will be a challenge for many in our community. Some may choose to worship in other locations. I hope that few will make this choice.

Regardless, I ask for your prayers and your support as we continue to seek God's inspiration and discern a plan for this transition.

Yours in His Service,

Michael Bechard (Rev.)

# FORWARD IN HOPE

SUNDAY, OCTOBER 23, 2016

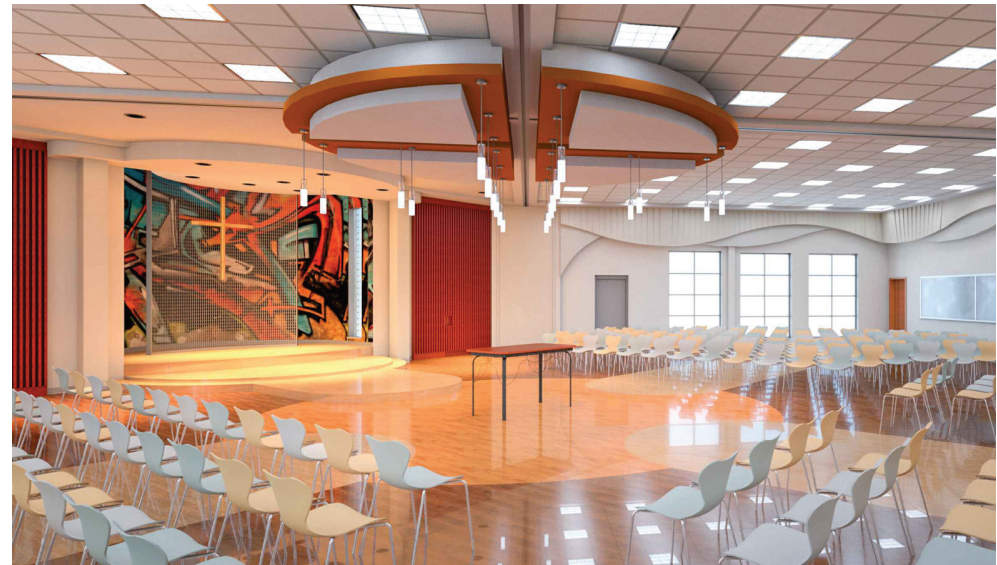

*Conceptual illustration of renovated Labatt Hall*



CHRIST THE KING UNIVERSITY PARISH  
OFFICE OF CAMPUS MINISTRY  
KING'S UNIVERSITY COLLEGE

Brothers and Sisters,

I write today as your pastor to invite you into an important conversation around the consolidation of our three worship spaces into one place at King's University College. I do so after much thought and prayer. The recent need to renew our lease has made these concerns even more pressing.

Over the last few years there has been a growing list of problems with our worship space that has made it difficult for our community to grow and to prosper.

The rental of the facility is becoming increasingly less manageable for a community our size. The renting of "The Chapel" will be over \$55,000 per year as of January 2017 and the bills to clean the facility are over \$10,000 per year. Half of our income is currently being spent on rent. Realistically, when we use the building for approximately 12 hours per week, it is difficult to reconcile these numbers and claim to be good stewards.

Finances are not our only problem.

While all of us can agree that the space at "The Mount" is beautiful for worship, it fails to meet many of our other needs. There is not a place for us to gather which reflects our size or our need for programming space.

There is limited parking and what parking there is, is quickly disappearing.

There have been two break-ins which have resulted in our property being stolen.

The bathrooms at "The Mount" are inadequate for our size, the facilities downstairs are not easily accessible and we lack change tables for our young families.

The organ will continue to need repairs and the sound system needs to be overhauled.

"For I know the plans I have for you," declares the LORD, "plans to prosper you and not to harm you, plans to give you hope and a future."

- Jeremiah 29:11 NIV

There are other issues that we have encountered in having to share a facility with a variety of other groups who do not necessarily share our interests and priorities.

We have been asked not to use incense in the facility because it affects the dance academy below.

We are limited as to when we can celebrate funerals and weddings. We are limited as to what hours we can use the building.

Our lease will expire in January and, after a great deal of conversation at King's, it will be extended for one year. Therefore, we will leave "The Chapel" at Windermere on the Mount in January 2018.

Thereafter, our Sunday gatherings will take place in Labatt Hall.

My initial thoughts are that we will celebrate liturgy twice on Sunday mornings and that we will need to continue an afternoon liturgy while the students are in session. Many of you are familiar with Labatt Hall, as it has been the location for our 5:00 pm celebration for over 10 years. Many of our lectures have taken place there and the choir has regularly filled the hall with their music.

It is my hope that we will be able to renovate the space in Labatt Hall over the next two years to make the place more aesthetically pleasing and more conducive to worship. Donations and monies saved from rent will facilitate this work.

There are a number of reasons that make relocation to King's appealing. There are, for example, more parking spaces, more bathrooms, more programming space and a significantly reduced overhead for operation.